

# Mline 854 B32

**Facade:**



**Layout:**

**MLine 854 B32**

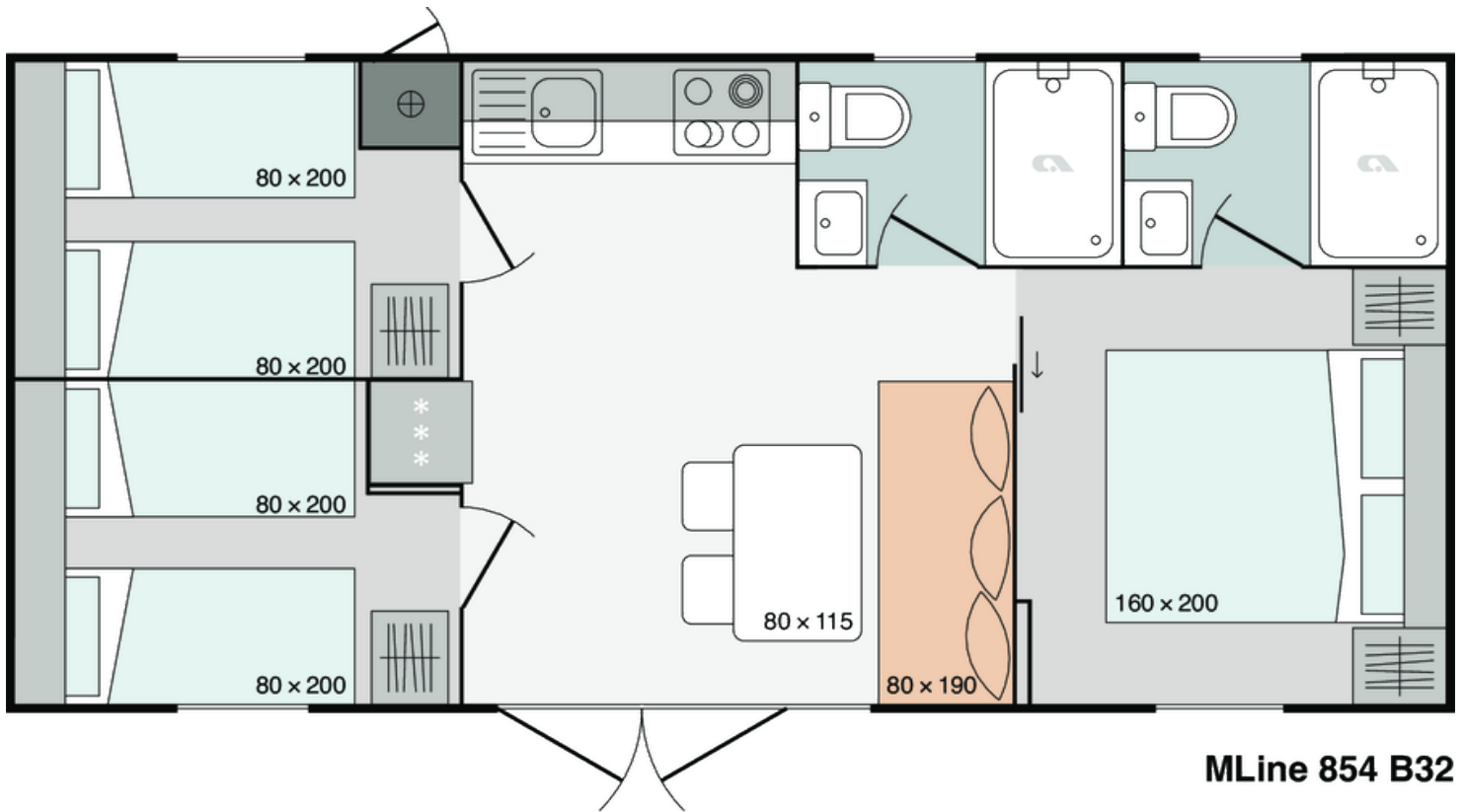

**A1 GENERAL**

Area	34,00
Number of beds	6+1
Number of bedrooms	3
Number of bathrooms	2
Length	8,50
Width	4,00
Height	3,45

**B1 CHASSIS**

100% Galvanized Steel Chassis	X
Single inflatable wheels	X
Detachable hook	X
Leveling Feet	X

**B2 FLOOR**

Vynil flooring	X
Moisture resistant CTB-H flooring 19 mm	X
Floor insulation aluminium foil	X
Adria Sandwich Technology ® Floor 40 mm	O

**B3 EXTERIOR WALLS**

Adria Sandwich Technology ®AST	X
Decorative attic: White panel	X
Decorative attic: Anthracite panel	O
Decorative attic: Compact White F2010 Malibu	O
Decorative attic: Compact Anthracite F2297 Terril	O
Frontal Facade: White Panel	O
Frontal Facade: Compact White F2010 Malibu	O
Frontal Facade: Compact Anthracite F2297 Terril	O
Frontal Facade: Larchwood vertical	O
Frontal Facade: Larchwood horizontal	O
Frontal Facade: Larchwood Blackline horizontal	O
Frontal Facade: Facade VANILLA Jub Family 325	O
Frontal Facade: Facade GREEN Jub Vitality 115	O

Frontal Facade: Facade BROWN GREY Jub Family 15	O
Frontal Facade: Facade BLUE Jub Vitality 20	O
Facade L/R: Facade without final layer	X
Facade L/R: Facade VANILLA Jub Family 325	O
Facade L/R: Facade GREEN Jub Vitality 115	O
Facade L/R: Facade BLUE Jub Vitality 20	O
Facade L/R: Facade MINT Jub Fate 45	O
Facade L/R: Facade BROWN GREY Jub Family 15	O
Facade L/R: White Metal Panel	O
Facade L/R: Anthracite Metal Panel	O
Facade L/R: Adria PVC Whiteline horizontal	O
Facade L/R: Adria PVC Blackline horizontal	O
Facade L/R: Larchwood horizontal	O
Facade L/R: Larchwood vertical	O
Facade L/R: Larchwood Blackline horizontal	O
Facade L/R: Larchwood double covering vertical	O
Facade L/R: Classic PVC White FS-201 horizontal	O
Facade L/R: Classic PVC Light Grey FS-201 horizontal	O
Facade L/R: Classic PVC Claystone FS-201 horizontal	O
Facade L/R: Classic PVC Anthracite FS-201 horizontal	O
Facade L/R: Classic PVC Silver Grey FS-201 horizontal	O
Facade L/R: Trend PVC Ivory SOFT FS-301 vertical	O
Facade L/R: Trend PVC Mastic SOFT FS-301 vertical	O
Facade L/R: Trend PVC Anthracite SOFT FS-301 vertical	O
Facade L/R: Trend PVC Pearl Grey STONE FS-301 vertical	O
Decorative Cladding: Facade without final layer	X
Decorative Cladding: Facade MINT Jub Fate 45	O
Decorative Cladding: Facade VANILLA Jub Family 325	O
Decorative Cladding: Facade GREEN Jub Vitality 115	O
Decorative Cladding: Facade BLUE Jub Vitality 20	O
Decorative Cladding: Facade BROWN GREY Jub Family 15	O
Decorative Cladding: White Panel	O
Decorative Cladding: Anthracite panel	O
Decorative Cladding: Larchwood vertical	O
Decorative Cladding: Larchwood Blackline horizontal	O

Decorative Cladding: Adria PVC Whiteline horizontal	O
Decorative Cladding: Classic PVC White FS-201 horizontal	O
Decorative Cladding: Classic PVC Light Grey FS-201 horizontal	O
Decorative Cladding: Classic PVC Claystone FS-201 horizontal	O
Decorative Cladding: Classic PVC Anthracite FS-201 horizontal	O
Decorative Cladding: Classic PVC Silver Grey FS-201 horizontal	O
Decorative Cladding: Trend PVC Ivory SOFT FS-301 vertical	O
Decorative Cladding: Trend PVC Mastic SOFT FS-301 vertical	O
Decorative Cladding: Trend PVC Anthracite SOFT FS-301 vertical	O
Decorative Cladding: Trend PVC Pearl Grey STONE FS-301 vertical	O
Cladding: Soft PVC Vnyl Silver Cedar vertical	X
Cladding: Classic PVC White FS-201 horizontal	O
Cladding: Classic PVC Light Grey FS-201 horizontal	O
Cladding: Classic PVC Claystone FS-201 horizontal	O
Cladding: Classic PVC Anthracite FS-201 horizontal	O
Cladding: Classic PVC Silver Grey FS-201 horizontal	O
Cladding: Trend PVC Ivory SOFT FS-301 vertical	O
Cladding: Trend PVC Mastic SOFT FS-301 vertical	O
Cladding: Trend PVC Anthracite SOFT FS-301 vertical	O
Cladding: Trend PVC Pearl Grey STONE FS-301 vertical	O
Cladding: Modern PVC White FS-302 vertical	O
Cladding: Modern PVC Claystone FS-302 vertical	O
Cladding: Modern PVC Pearl Grey FS-302 vertical	O
Cladding: Modern PVC Anthracite FS-302 vertical	O
Cladding: Facade VANILLA Jub Family 325	O
Cladding: Facade GREEN Jub Vitality 115	O
Cladding: Facade BLUE Jub Vitality 20	O
Cladding: Facade BROWN GREY Jub Family 15	O
Cladding: Larchwood Vertical	O
Cladding: Larchwood Horizontal	O
Cladding: Larchwood Blackline horizontal	O
Corners: Color of cladding	X
Decorative Cladding: Larchwood horizontal	O
Cladding: Adria PVC Whiteline horizontal	O
Cladding: Adria PVC blackline horizontal	O

**B4 WINDOWS AND DOORS**

PVC white windows and doors with termopan glass	X
PVC anthracite windows and doors with termopan glass	O
Tinted windows in bathrooms	X
Swing entrance door with security glass	X
Panoramic sliding entrance door with security glass	O
PVC balcony door in bedroom with security glass	O
Door holder	X
Mosquito nets on all windows - white	O
Built-in blinds on all windows	O
Rolo shutters on bathroom windows	O
Master cylinder	O
Master key	O
ALU door of external box	X

**B5 ROOF AND CEILING**

Single-pitched Roof	X
Roof construction class A (150 kg/m <sup>2</sup> )	X
Roof construction class B (250 kg/m <sup>2</sup> )	O
Galvanized steel roof	X
Roof colour: White	X
Roof Colour: Anthracite	O
PVC roof	O
PVC foil	X
Roof insulation glass wool 50 mm with	X
Roof insulation glass wool 100 mm with	O
Flat heigher ceiling in all rooms 225 cm	X
Gutters	X
Vertical draining pipes	O
Gutter guard for leaves	O

**C0 INTERIOR**

Textile Combination - STANDARD	PARIS 2022
Textile Combination - OPTION 1	MARSEILLES 2022
Textile Combination - OPTION 2	MILANO 2022

Textile Combination - OPTION 3	RIMINI 2022
Furnishing Decor	NATURAL 2022
Dimout curtains	X
Daily curtains	O
Sofa Cushions - STANDARD	SILVER MAGIC 2022
Sofa Cushions - OPTION 1	FRESH WIND 2022
Sofa Cushions - OPTION 2	DIAMOND SPARKLE 2022
Sofa Cushions - OPTION 3	GOLDEN STAR 2022
Interior separation walls 16 mm	X
Interior doors 25 mm with PVC doorframes	X
Door stopper	X
Metal doorhooks	X
Soft close for furniture	X

### C1 LIVING ROOM

Sofa	X
Sofa extendable	O
Sofa with decorative seams	O
Sofa with decorative seams extendable	O
Upholstered headboard for the sofa	O
Dinning table	X
Coffee table	O
Chairs	X
Wall shelf over the sofa	X
Hangers	X
Mirror	X
Fire extinguisher	O
Fire blanket	O
Smoke detector	O
Decorativ wall in living room	X

### C2 KITCHEN

Gas hob on glass ceramic platform 4 burners	X
Glas ceramic hob with 4 burners	O
Induction hob with 4 burners	O



Shelving in kitchen	O
Built-in extractor hood	X
Stainless steel sink with drainer	X
Granite sink with drainer	O
Built-in bin separator 16L	O
Selfstanding grey fridge with freezer 217l	X
Built-in fridge with freezer 270 l	O
Built-in dishwasher 450 mm	O
Microwave oven	O
Built-in microwave oven	O
Built-in drainer (scolapiatti)	O
Kitchen backsplash: Glass white wall panel	X
Kitchen backsplash: White wall panel	O
Kitchen backsplash: Decorative laminate	X
Wooden wall panel with shelve over fridge	X

### C3 MASTER BEDROOM

Double bed with slatted bed base	160 x 200
Foam mattresses (25 kg/m <sup>2</sup> )	X
Foam mattresses (35 kg/m <sup>2</sup> )	O
Wooden bed upholstery	O
Upholstered bed	O
Ottoman upholstered bed	O
Ottoman bed with wooden upholstery	O
Wooden headboard	X
Upholstered headboard	O
Bedside tables	X
Wall shelf over the bed	X
Decorative wall panel above shelve	O
Cupboards over the bed	O
Wardrobe	X
Hangers	X
Mirror	X
Safe in master bedroom	O

**C4 CHILDREN BEDROOM**

Single beds with slatted bed base	80 x 200
Loft bed	O
Foam mattresses PN25	X
Foam mattresses HR35	O
Wooden bed upholstery	O
Upholstered bed	O
Underbed	O
Wooden headboard	X
Upholstered headboard	O
Wooden wall panel alongside bed	O
Upholstered wall panel alongside bed	O
Bedside tables	X
Wall shelf over the bed	X
Decorative wall panel above shelve	O
Cupboards over the bed	O
Wardrobe	X
Hangers	O
Mirror	O

**C5 CHILDREN BEDROOM 2**

Single beds with slatted bed base	80 x 200
Loft bed	O
Foam mattresses PN25	X
Foam mattresses HR35	O
Underbed	O
Wooden headboard	X
Upholstered headboard	O
Wooden wall panel alongside bed	O
Upholstered wall panel alongside bed	O
Bedside tables	X
Wall shelf over the bed	X
Decorative wall panel above shelve	O
Cupboards over the bed	O

Wardrobe	X
Hangers	O
Mirror	O

## C6 BATHROOM

Shower cabin	80 x 120
Shower sliding doors with security glass	X
Shower PVC wall	X
Shower rail with sliding shower holder	X
Shower rail with adjustable sliding shower holder and rain shower head	O
Wash-stand with mixer tap	X
Mirror with shelf	X
Ceramic toilet with toilet seat	X
PVC toilet tank with saving function	X
Built-in toilet tank with saving function	O
Built-in toilet tank with saving function connected to wash-stand	O
Towel holder	X
Toilet roll holder	X
Hangers	X
Hairdryer	O

## C7 BATHROOM 2

Shower tray	80 x 120
Shower sliding doors with security glass	X
Shower PVC wall	X
Shower rail with sliding shower holder	X
Shower rail with adjustable sliding shower holder and rain shower head	O
Wash-stand with mixer tap	X
Mirror with shelf	X
Ceramic toilet with toilet seat	X
PVC toilet tank with saving function	X
Built-in toilet tank with saving function	O
Built-in toilet tank with saving function connected to wash-stand	O
Towel holder	X

Toilet roll holder	X
Hangers	X
Hairdryer	O

## D1 WATER AND GAS

External connector to water facilities with	X
Connection to central warmwater system	O
Connection to central wastewater system	O
PVC water pipes Speedfit®	X
Central waste water outlet	O
Water filter	O
External access to water heater	X
Gas water heater Vaillant 11l natural push	X
Gas connection in box: Propan/Butan 30 mBar	X
External gas connection: Methan	O
Electrical water heater 50l	O
Electrical water heater 80l	O
Electrical water heater 100l	O

## D2 ELECTRICITY

White flush mounted installations, sockets and switches	X
External connection 32A, 250V, 2P+E	X
External connection 32A, 400V, 3P+N+E	O
Awning LED light	X
LED strip above entrance	O
External socket	X
External socket anthracite	O
External socket under chassis	O
Built-in ceiling spot LED lights in all rooms	X
Reading LED lights in all rooms	X
Ambiental LED lightning in living room and sleeping rooms	O
LED lightning in kitchen	O
Preinstallation for Airconditioning	X
Key lock	O
Airco Card	O

Airco sensors for entrance door	<input type="radio"/>
Airco sensors for all windows except bathrom	<input type="radio"/>
TV socket	<input checked="" type="radio"/>
Aditonal TV and aerial socket in master bedroom	<input type="radio"/>
USB socket	<input type="radio"/>
UTP socket	<input type="radio"/>
Ambiental LED lightning in living room	<input type="radio"/>

**D3 MULTIMEDIA**

TV holder	<input type="radio"/>
TV holder with double fold function	<input type="radio"/>
LED TV 32 inch	<input type="radio"/>
Adria Bluetooth sound system	<input type="radio"/>

**D4 HEATING AND COOLING**

Air-conditioning - mono split	<input type="radio"/>
Air-conditioning - duo split	<input type="radio"/>
Electrical heater in living room	<input type="radio"/>
Electrical heater in bedrooms	<input type="radio"/>
Electrical towel heater in bathroom	<input type="radio"/>
Electrical underfloor heating system Ebecco ® in all rooms	<input type="radio"/>
Insulated water pipes with electrical heating	<input type="radio"/>
Gas central heating system with radiators	<input type="radio"/>

**E1 EXTERIOR EQUIPMENT**

Terrace	<input type="radio"/>
---------	-----------------------

**Legal Notice**

The information on this website is provided "as is" and without warranty of any kind, expressed or implied, including (but not limited to) any implied warranties of merchantability and non-infringement of third party rights. While the information provided is believed to be accurate, it may include errors or inaccuracies. In no event shall Adria Home be liable to any person for any special, indirect or consequential damages relating to this material, unless caused by gross negligence or intentional misconduct. The purpose of this website is illustrative. The website may show visuals which may include some elements not belonging to the standard equipment or portray products which may not be available in all markets. Products may change in terms of technical specification and commercial details and in relation to specific regulations. You are advised to always contact your selected Adria representative to obtain all detailed information prior to purchasing.

**Copyright**

Copyright © Adria Home Ltd., ?rnomej, Slovenia 2019-20. All rights reserved. The text, images, graphics, sound files, animation files, video files, and their arrangement on the Adria Home website are all subject to copyright and other intellectual property protection. These objects may not be copied for commercial use or distribution, nor may these objects be modified or reposted to other sites. Adria Home website may contain images whose copyrights are attributable to third parties.



Adria Home Ltd.

Kanižarica 41, SI-8340 ?rnomej, Slovenija, Tel: +386 (0) 7 35 69 100, E-mail: info@adria-home.com

adria-home.com , www.adria-holidays.net

#AdriaHome  
#AdriaGlamping