



Aurora Twin 907 F31T

Facade:



Facade 2:



Layout:



Layout 2:

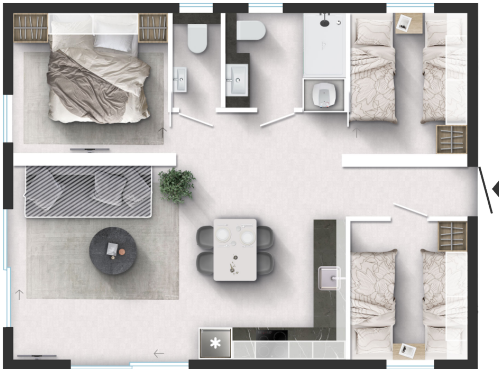

A1 GENERAL

Area	63,00
Number of beds	2+1+4
Number of bedrooms	1+2
Height	3,45
Length	9,00
Width	7,00
Number of bathrooms	1 + T

B1 CHASSIS

100% Galvanized Steel Chassis with leveling feet	X
Inflatable wheels	X
Detachable hook	X
Leveling Feet	X

B2 FLOOR

Vynil flooring	X
Bitumen floor protection	X
Structural Insulated Panels SIP Floor 100mm (R=2,39 m2K/W)	X

B3 EXTERIOR WALLS

Structural Insulated Panels SIP 100mm (R=2,39 m2K/W)	X
Inner surface finish of external walls - White (ButtenUnniWeiss)	X
Decorative attic: Compact - matching colour of windows and doors	X
Decorative Cladding: Larchwood vertical	O
Decorative Cladding: Larchwood Blackline horizontal	O
Decorative Cladding: Adria PVC Whiteline horizontal	O
Decorative Cladding: Larchwood horizontal	O
Decorative Cladding: Adria PVC Blackline horizontal	O
Decorative Cladding: Compact Anthracite	X
Decorative Cladding: Compact White	O
Other Three Sides: Compact anthracite	O
Other Three Sides: Compact white	O
Other Three Sides: Adria PVC Whiteline horizontal	O
Other Three Sides: Adria PVC blackline horizontal	O

Other Three Sides: Larchwood Horizontal	O
Other Three Sides: Larchwood Vertical	O
Other Three Sides: Larchwood Blackline horizontal	X
Corners: Color of cladding	X

B4 WINDOWS AND DOORS

Tinted windows in bathrooms	X
PVC windows and doors with termopan glass - anthracite outside, white inside	X
Windows and doors with higher insulation (U=1,3 W/m2K)	X
Interior wooden window trim white	X
External installation of windows and doors	X
Swing entrance door with security glass and door holder	X
PVC balcony door in kitchen with security glass	X
PVC balcony door in living room with security glass	X
Mosquito nets on all windows - matching colour of windows	O
Master cylinder	O
Master key (3 pieces)	O
PVC balcony door in bedroom with security glass	X

B5 ROOF AND CEILING

Single-pitched Roof with integrated gutter	X
Roof construction class D (300 kg/m2)	X
Roof Colour: Anthracite	X
Roof type: PVC roof	X
Roof insulation glass wool 100 mm (R=3,10 m2K/W)	X
Flat ceiling in all rooms - height 240 cm	X
Vertical draining pipes - matching colour of windows and doors	X
Electric heated gutters and vertical drain pipes	O

C0 INTERIOR

Furnishing Decor - STANDARD	GRAPHITE 2022
Textile Combination - STANDARD	GRAPHITE 2022
Dimout curtains in all rooms except bathroom and toilet	X
Daily curtains in all rooms except bathroom and toilet	O
Cushions in bedrooms	O

Interior doors 40 mm with ALU doorframes	X
Door stopper	X
Metal doorhooks	X
Soft close for furniture	X
Double interior separation walls	X
Internal skirtings	X
Fire extinguisher (1kg)	O
Fire blanket	O
Smoke detector	O
Bathroom and toilet door with lock	X

C1 LIVING ROOM

Dinning table	X
Designer comfortable sofa extendable	O
Chairs	X
Wall shelf over the sofa in living room	X
Decorative wall in living room	X
Hangers in living room (2 pcs)	X
Mirror in living room	X
Electrical sockets in living room (2x)	X
Built-in ceiling spot LED lights in living room with 2-way switch	X
TV module in living room (1x TV socket, 2x el. socket)	X
UTP socket in living room	O
Ambiental LED lightning in living room	X
Adria Bluetooth sound system	O

C2 KITCHEN

Glass ceramic hob with 4 burners	X
Induction hob with 4 burners	O
Built-in extrator hood	X
Stainless steel sink without drainer	X
Built-in bin separator 16L	O
Built-in frdige with freezer	X
Built-in dishwasher 600mm	O
Pre-preparation of installations for built-in dishwasher	X

Built-in electrical oven 600 mm	O
Built-in microwave oven	O
Pre-preparation of installations for built-in oven	X
Built-in electrical oven with microwave function 600 mm	O
Kitchen backsplash: White wall panel	X
Electrical sockets over the kitchen counter (2x)	X
Built-in ceiling spot LED lights in kitchen	X
LED lightning above kitchen counter	X

C5 CHILDREN BEDROOM 2

Single beds with slatted bed base	80x200
Foam mattresses PN25 in children's bedroom 2	X
Foam mattresses HR35 in children's bedroom 2	O
Upholstered headboard in children's bedroom 2	X
Bedside tables in children's bedroom 2	X
Wall shelf over the bed in children's bedroom 2	X
Cupboards over the bed in children's room 2	X
Wardrobe in children's bedroom 2	X
Decorative wall panel above shelve in children's bedroom 2	X
Hangers in children's room 2 (2 pcs)	O
Mirror in children's bedroom 2	O
Ambiental LED lightning under the shelf in children's bedroom 2	X
Reading LED lights in children's bedroom 2	X
Electrical sockets in children's bedroom 2 (2x)	X
USB charging module in children's bedroom 2 (1x C, 1x A)	O
Built-in ceiling spot LED lights in children's room 2 with 2-way switch	X

D1 WATER AND GAS

External connector to water facilities with pressure regulator	X
Additional connection to central wastewater system for toilet tank	O
Water filter in technical box	O
PVC water pipes Speedfit®	X
Central waste water outlet	O
Insulated water pipes with electrical heating	X
Internal access to water heater - door with lock	X

Electrical water heater 100l	X
------------------------------	---

D2 ELECTRICITY

External connection 32A, 400V, 3P+N+E	X
Black flush installations, sockets and switches	X
Key lock	O

D3 MULTIMEDIA

TV holder	O
LED TV 32 inch	O
TV holder with double fold function	O
LED TV 43 inch	O

D4 HEATING AND COOLING

Preinstallation for Airconditioning in living room	X
Airco sensors for all windows except bathrom	O
Airco Card	O
Air-conditioning white - mono split	O
Electrical underfloor heating system Ebecco ® in all rooms	X
Gas central heating system with radiators	O
Electric central heating system Eloblock with radiators	O
Air-conditioning black with fix wall thermostate - mono split	O
IR heating system with fixed thermostat in each room	X
Electrical towel heater in bathroom 1	X
Additional control of underfloor heating in the bathroom	X
Electrical towel heater in separate toilet	O

E1 EXTERIOR EQUIPMENT

External socket - matching colour of windows and doors	X
External socket under chassis	O
Exterior LED lightning	X

C3 MASTER BEDROOM

Safe in master bedroom	O
Double bed with slatted bed base	160x200
Foam mattresses (25 kg/m2) in master bedroom	X
Foam mattresses (35 kg/m2) in master bedroom	O

Upholstered bed in master bedroom	O
Ottoman upholstered bed in master bedroom	O
Wooden bed upholstery in master bedroom	X
Ottoman bed with wooden upholstery in master bedroom	O
Upholstered headboard in master bedroom	X
Decorative wall panel in master bedroom	X
Bedside tables in master bedroom	X
Cupboards over the bed in master bedroom	X
Wardrobe in master bedroom	X
Hangers in master bedroom (2 pcs)	X
Mirror in master bedroom	X
Ambiental LED lightning under the shelf in master bedroom	X
Reading LED lights in master bedroom	X
USB charging modules in master bedroom (2 x C, 2 x A)	O
Built-in ceiling spot LED lights in master bedroom with 2-way switch	X
Electrical sockets in master bedroom (2x)	X
UTP socket in master bedroom	O
TV module in master bedroom (1x TV socket, 2x socket)	O

C4 CHILDREN BEDROOM

Single beds with slatted bed base	80x200
Foam mattresses PN25 in children's bedroom	X
Foam mattresses HR35 in children's bedroom	O
Upholstered headboard in children's bedroom	X
Bedside tables in children's bedroom	X
Wooden bed upholstery in children's bedroom	X
Upholstered bed in children's bedroom	O
Wall shelf over the bed in children's bedroom	X
Cupboards over the bed in children's bedroom	X
Wardrobe in children's bedroom	X
Decorative wall panel above shelve in children's bedroom	X
Hangers in children's bedroom (2 pcs)	O
Mirror in children's bedroom	O
Ambiental LED lightning under the shelf in children's bedroom	X
Reading LED lights in children's bedroom	X

Electrical sockets in children's bedroom (2 pcs)	X
USB charging module in children's bedroom (1x C, 1x A)	O
Built-in ceiling spot LED lights in children's bedroom with 2-way switch	X

C6 BATHROOM

Shower cabin with low profile tray and decorative PVC shower wall	80 x 120
Shower sliding doors with security glass	X
Shower rail with adjustable sliding shower holder and rain shower head	X
Wash-stand with two drawers and mixer tap	X
Mirror in bathroom 1	X
Ceramic toilet with toilet seat	X
Toilet roll holder	X
Hangers in bathroom (2 pcs)	X
Built-in toilet tank with saving function	X
Hairdryer in bathroom	O
Built-in ceiling spot LED lights in bathroom	X
Electrical socket in bathroom	X
Fan wit humidity sensor on light switch and timer delay in bathroom 1	X

C8 SEPARATE TOILET

Wash-basin with mixer tap	X
Mirror in separate toilet	X
Ceramic toilet with toilet seat	X
Built-in toilet tank with saving function	X
Toilet roll holder	X
Hanger in separate toilet (1 pcs)	X
Built-in ceiling spot LED lights in toilet	X
Fan with time delay switch in separate toilet	X

Legal Notice

The information on this website is provided "as is" and without warranty of any kind, expressed or implied, including (but not limited to) any implied warranties of merchantability and non-infringement of third party rights. While the information provided is believed to be accurate, it may include errors or inaccuracies. In no event shall Adria Home be liable to any person for any special, indirect or consequential damages relating to this material, unless caused by gross negligence or intentional misconduct. The purpose of this website is illustrative. The website may show visuals which may include some elements not belonging to the standard equipment or portray products which may not be available in all markets. Products may change in terms of technical specification and commercial details and in relation to specific regulations. You are advised to always contact your selected Adria representative to obtain all detailed information prior to purchasing.

Copyright

Copyright © Adria Home Ltd., Črnomelj, Slovenia 2019-20. All rights reserved. The text, images, graphics, sound files, animation files, video files, and their arrangement on the Adria Home website are all subject to copyright and other intellectual property protection. These objects may not be copied for commercial use or distribution, nor may these objects be modified or reposted to other sites. Adria Home website may contain images whose copyrights are attributable to third parties.

Adria Home Ltd.

Kanižarica 135, SI-8340 Črnomelj, Slovenija,

Tel: +386 (0) 7 35 69 100

E-mail: info@adria-home.com**adria-home.com, www.adria-holidays.net**#AdriaHome
#AdriaGlamping